



## House Measurements & Floor Plan

Property Address:  
**4037 Yellowfield Way, Cary, NC 27518**

Prepared for:  
**Glenn Pilcher**  
**Fonville Morisey - Lochmere**  
**April 24, 2018**



**Farshid Bondar**  
**(919) 917-5490**  
**TRIANGLE APPRAISING SERVICES**

# FLOOR PLAN & INTERIOR DIMENSIONS

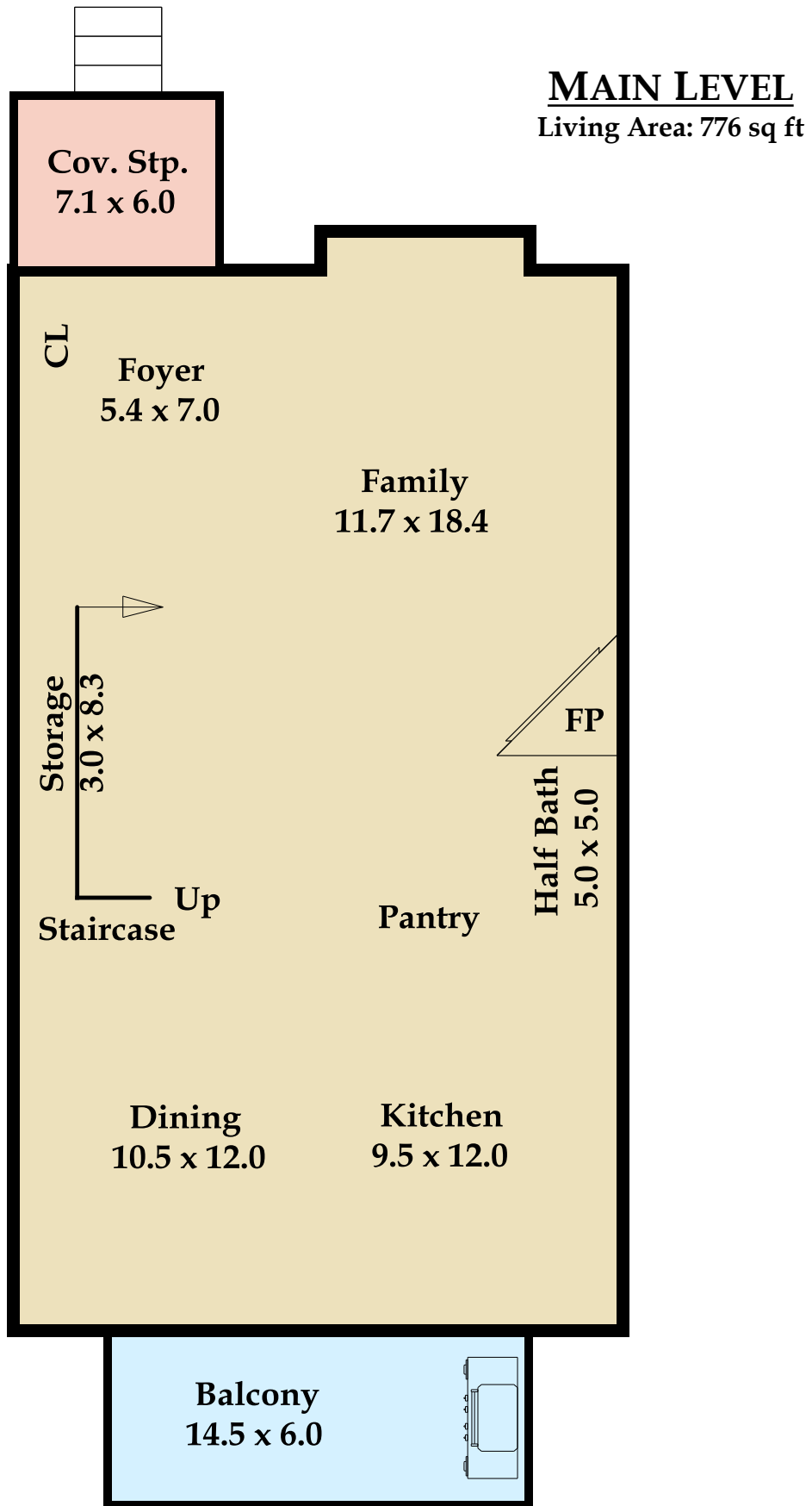

This floor plan is an approximation of existing structures and features and is provided for convenience only with the permission of the seller. All measurements are approximate and not guaranteed to be exact or to scale. Buyer should confirm measurements using their own sources. It is assumed that all workmanship in the existing property has been done according to local industry standards and permits duly obtained.

# FLOOR PLAN & INTERIOR DIMENSIONS

## UPPER LEVEL

Living Area: 755 sq ft

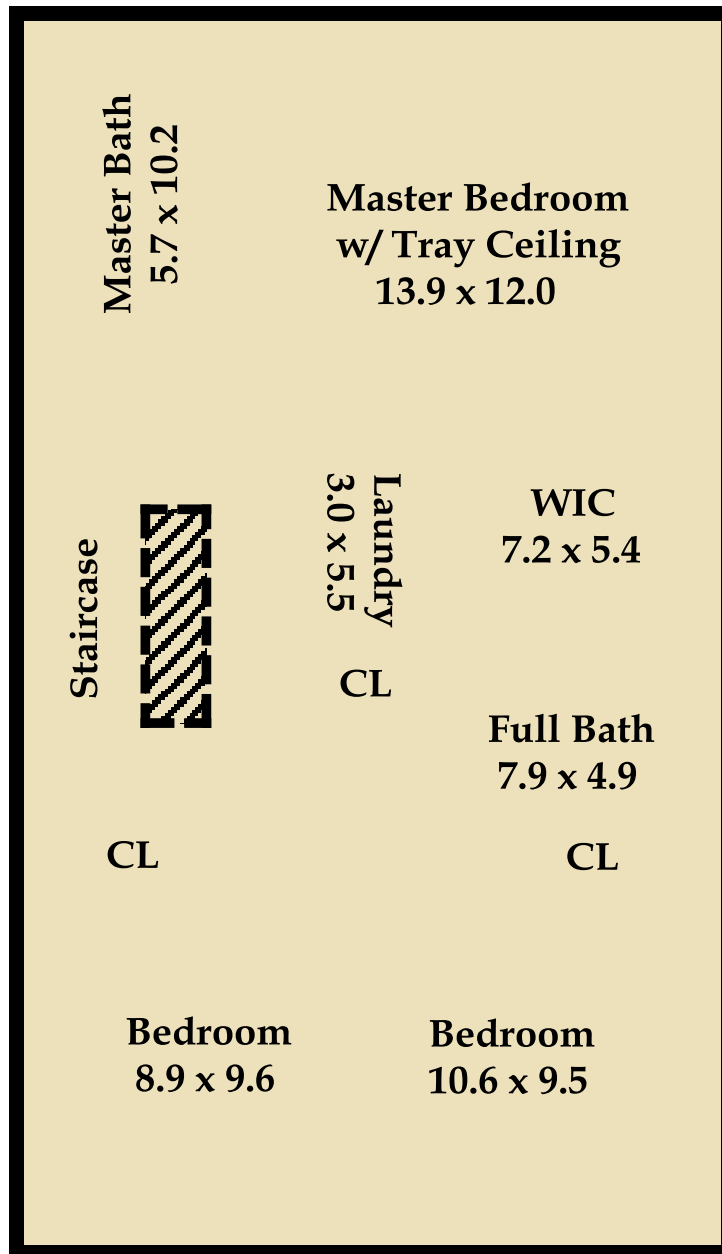

# FLOOR PLAN & INTERIOR DIMENSIONS

## LOWER LEVEL

Living Area: 331 sq ft

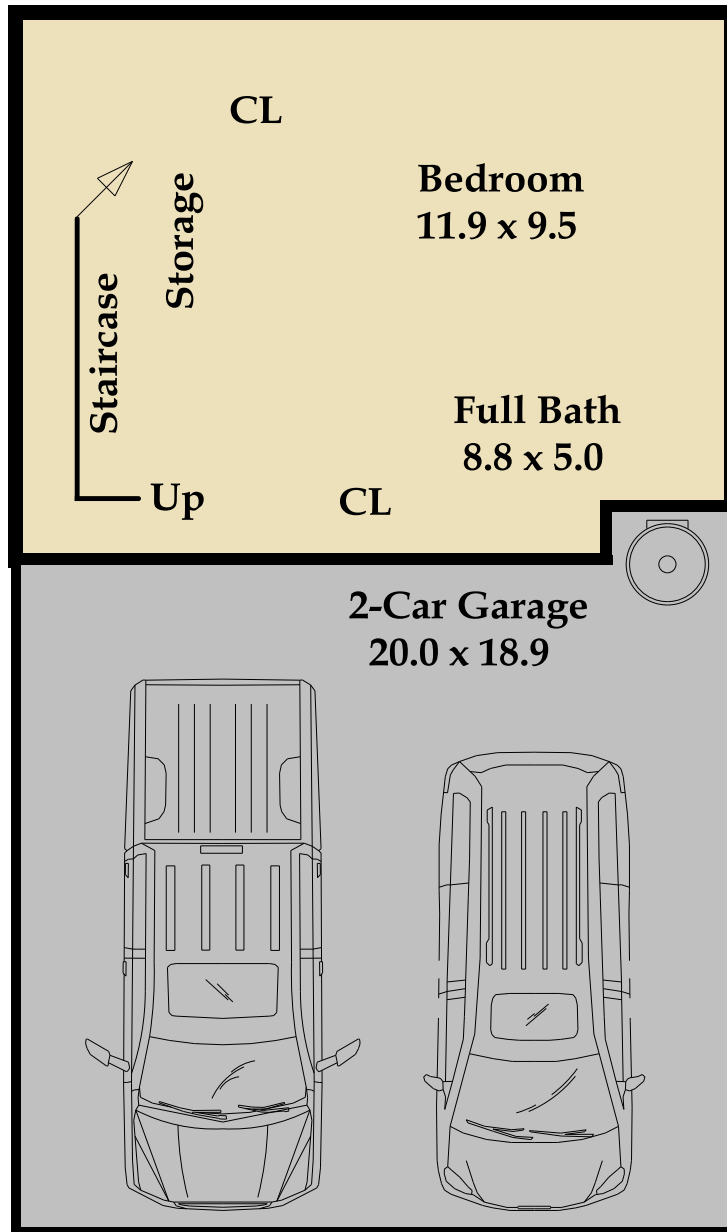

## LIVING AREA CALCULATION DETAILS

<b>TOTAL LIVING AREA:</b>	<b>1,863 sq ft</b>
<b>Main Level Living Area:</b>	<b>776 sq ft</b>
<b>Upper Level Living Area:</b>	<b>755 sq ft</b>
<b>Lower Level Living Area (below grade):</b>	<b>331 sq ft</b>
<b>Balcony Area:</b>	<b>87 sq ft</b>
<b>2-Car Garage Area:</b>	<b>419 sq ft</b>

<b>Living Area</b>	<b>Calculation Details</b>		
First Floor	776.22 Sq ft	$7.2 \times 1.35$	= 9.72
		$36.5 \times 21$	= 766.5
Open to Below	-11.34 Sq ft	$6.3 \times 1.8$	= 11.34
Second Floor	766.5 Sq ft	$36.5 \times 21$	= 766.5
Basement	331.39 Sq ft	$16.05 \times 17.35$	= 278.47
		$3.65 \times 14.5$	= 52.92
<b>Total Living Area (Rounded):</b>	<b>1863 Sq ft</b>		

### Usage License

Use of images and documents will be granted to the real estate agent client and their brokerage for the sole purpose of marketing the specific property, including distribution to the Triangle MLS, feeds, and syndication. This usage is limited to the duration of the listing as long as the real estate agent client is representing the sale of the property.

The real estate agent client may also use the documents listed above for an unlimited time period beyond the listing time frame in their local area for their self-promotion.

TRIANGLE APPRAISING SERVICES retains copyright of all images and documents.

Any usage of the images and documents by a third party, including but not limited to, a new listing agent, architects, builders, stagers, designers, sellers or buyers for commercial use is strictly prohibited unless approved in writing by TRIANGLE APPRAISING SERVICES. However, images and documents may be given to the seller of the property for non-commercial, personal use. This license is not transferable. If further usage is desired for additional time frames and/or uses by the client and/or another person or entity, TRIANGLE APPRAISING SERVICES encourages contact for an estimate of the fee(s) which may be incurred and to obtain written permission to do so.