



## House Measurements & Floor Plan

Property Address:  
**4804 Sinclair Dr., Raleigh, NC 27616**

Prepared for:  
**Gary Penny**  
**Fonville Morisey - Lochmere**  
**January 9, 2018**



**Farshid Bondar**  
**(919) 917-5490**  
**TRIANGLE APPRAISAL SERVICES**

# FLOOR PLAN & INTERIOR DIMENSIONS

## FIRST FLOOR

Living Area: 1,278 sq ft

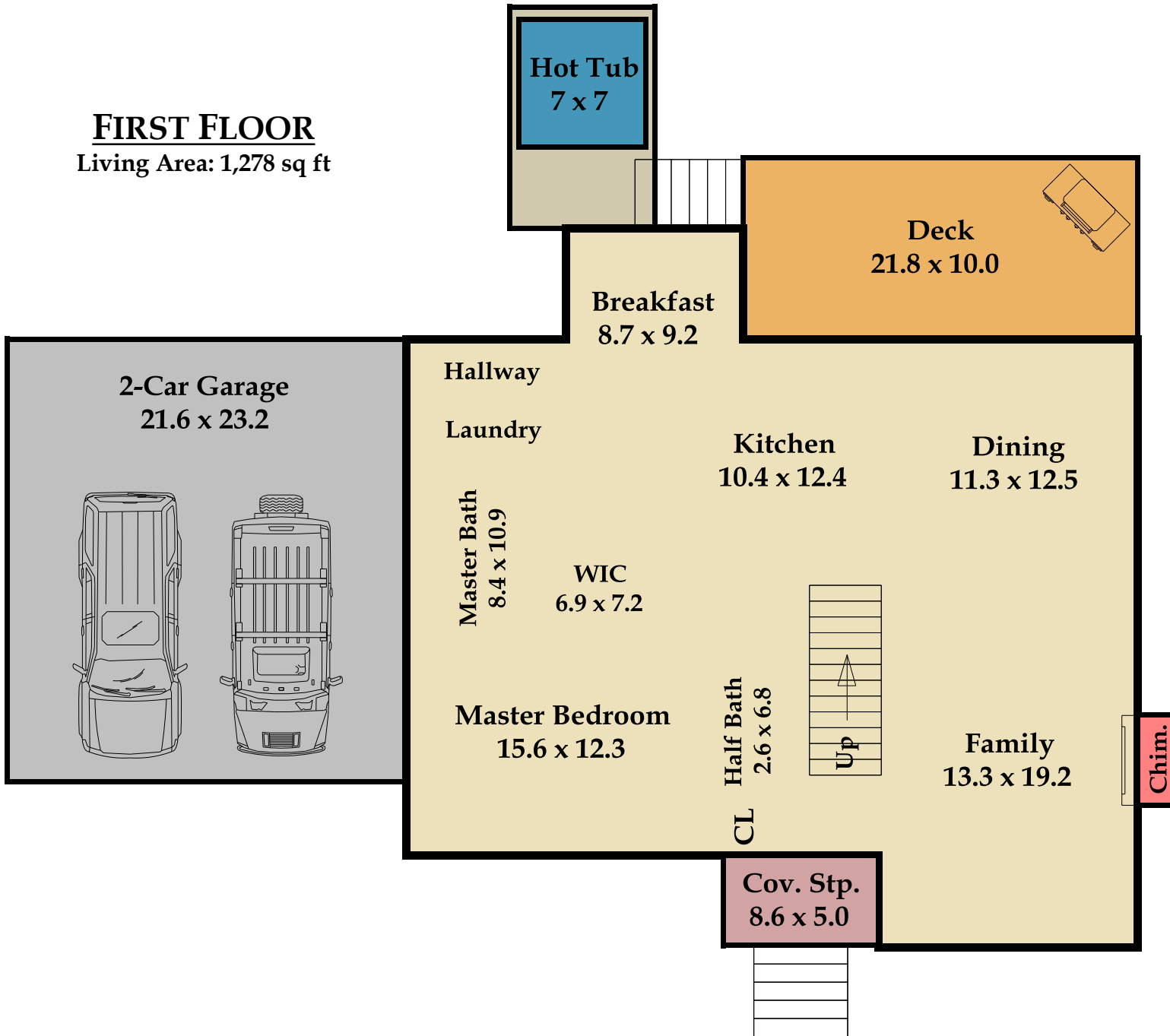

# FLOOR PLAN & INTERIOR DIMENSIONS

## SECOND FLOOR

Living Area: 1,157 sq ft

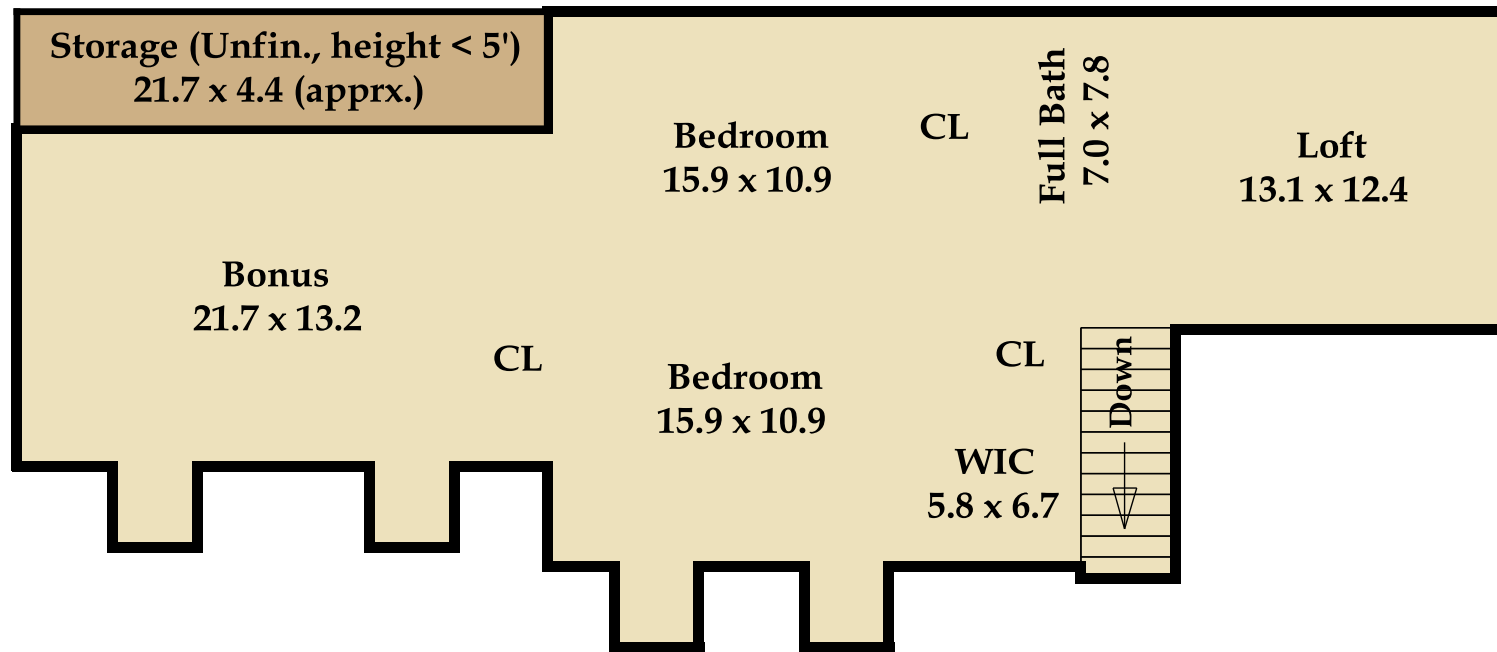

## LIVING AREA CALCULATION DETAILS

<b>TOTAL LIVING AREA:</b>	<b>2,435 sq ft</b>
<b>First Floor Living Area:</b>	<b>1,278 sq ft</b>
<b>Second Floor Living Area:</b>	<b>1,157 sq ft</b>
<b>Deck Area:</b>	<b>218 sq ft</b>

<b>Living Area</b>	<b>Calculation Details</b>
First Floor	<div style="display: flex; justify-content: space-between;"> <span>1278.22 Sq ft</span> <div style="text-align: right;"> <math>9.75 \times 6.1 = 59.48</math>  <math>28.45 \times 26 = 739.7</math>  <math>14.3 \times 33.5 = 479.05</math> </div> </div>
Second Floor	<div style="display: flex; justify-content: space-between;"> <span>1157 Sq ft</span> <div style="text-align: right;"> <math>3.55 \times 3.4 = 12.07</math>  <math>3.55 \times 3.4 = 12.07</math>  <math>3.55 \times 3.4 = 12.07</math>  <math>3.55 \times 3.4 = 12.07</math>  <math>14.1 \times 22.2 = 313.02</math>  <math>13.3 \times 13.8 = 183.54</math>  <math>23.2 \times 22.3 = 517.36</math>  <math>4 \times 23.7 = 94.8</math> </div> </div>
<b>Total Living Area (Rounded):</b>	<b>2435 Sq ft</b>

**Usage License**  
 Use of images and documents will be granted to the real estate agent client and their brokerage for the sole purpose of marketing the specific property, including distribution to the Triangle MLS, feeds, and syndication. This usage is limited to the duration of the listing as long as the real estate agent client is representing the sale of the property.  
 The real estate agent client may also use the documents listed above for an unlimited time period beyond the listing time frame in their local area for their self-promotion.  
 TRIANGLE APPRAISAL SERVICES retains copyright of all images and documents.  
 Any usage of the images and documents by a third party, including but not limited to, a new listing agent, architects, builders, stagers, designers, sellers or buyers for commercial use is strictly prohibited unless approved in writing by TRIANGLE APPRAISAL SERVICES. However, images and documents may be given to the seller of the property for non-commercial, personal use. This license is not transferable. If further usage is desired for additional time frames and/or uses by the client and/or another person or entity, TRIANGLE APPRAISAL SERVICES encourages contact for an estimate of the fee(s) which may be incurred and to obtain written permission to do so.