

House Measurements & Floor Plan

Property Address:
516 Auburn Square Dr., Durham, NC 27713

Prepared for:
Glenn Pilcher
Fonville Morisey - Lochmere
May 17, 2018



Farshid Bondar
(919) 917-5490
TRIANGLE APPRAISING SERVICES

FLOOR PLAN & INTERIOR DIMENSIONS

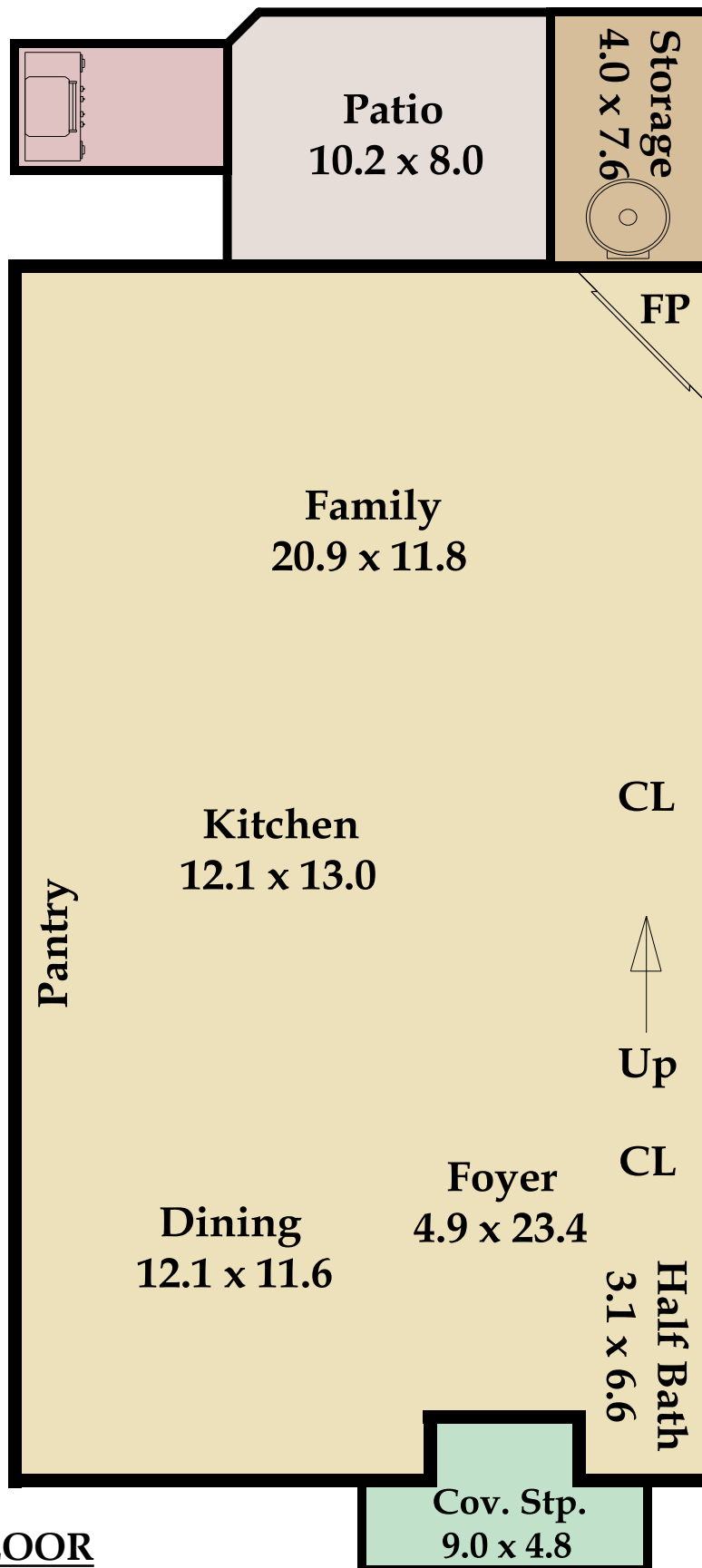

FIRST FLOOR

Living Area: 829 sq ft

This floor plan is an approximation of existing structures and features and is provided for convenience only with the permission of the seller. All measurements are approximate and not guaranteed to be exact or to scale. Buyer should confirm measurements using their own sources. It is assumed that all workmanship in the existing property has been done according to local industry standards and permits duly obtained.

FLOOR PLAN & INTERIOR DIMENSIONS

SECOND FLOOR

Living Area: 839 sq ft

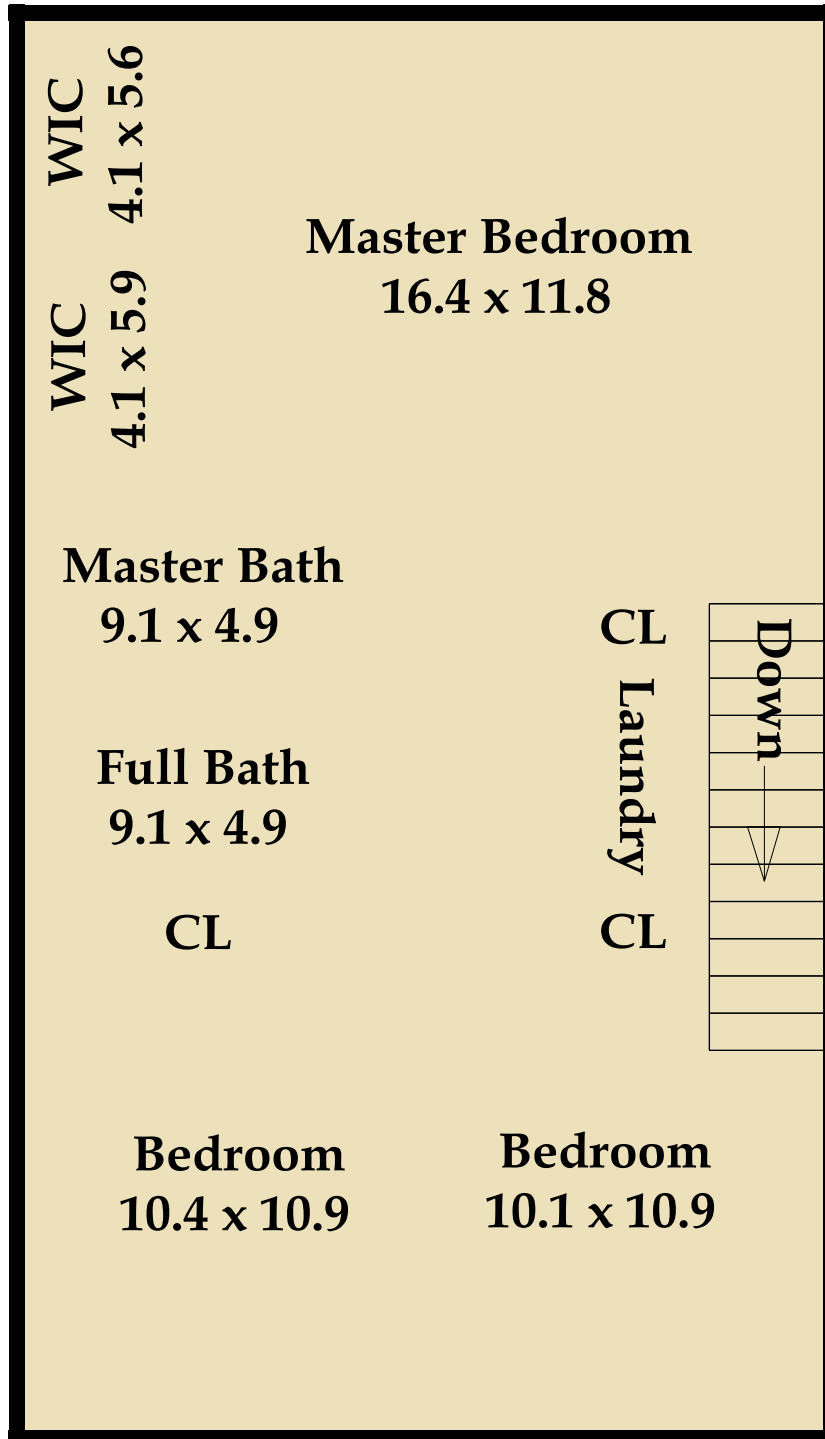

LIVING AREA CALCULATION DETAILS

TOTAL LIVING AREA:	1,668 sq ft
First Floor Living Area:	829 sq ft
Second Floor Living Area:	839 sq ft
Storage Area:	40 sq ft
Patio Area:	81 sq ft
Covered Stoop Area:	35 sq ft

Living Area	Calculation Details
First Floor	<div style="display: flex; justify-content: space-between;"> 829.37 Sq ft <div style="text-align: right;"> $21.9 \times 36.3 = 794.97$ $2 \times 4.1 = 8.2$ $2 \times 13.1 = 26.2$ </div> </div>
Second Floor	<div style="display: flex; justify-content: space-between;"> 838.77 Sq ft <div style="text-align: right;"> $38.3 \times 21.9 = 838.77$ </div> </div>
Total Living Area (Rounded):	1668 Sq ft

Usage License

Use of images and documents will be granted to the real estate agent client and their brokerage for the sole purpose of marketing the specific property, including distribution to the Triangle MLS, feeds, and syndication. This usage is limited to the duration of the listing as long as the real estate agent client is representing the sale of the property.

The real estate agent client may also use the documents listed above for an unlimited time period beyond the listing time frame in their local area for their self-promotion.

TRIANGLE APPRAISING SERVICES retains copyright of all images and documents.

Any usage of the images and documents by a third party, including but not limited to, a new listing agent, architects, builders, stagers, designers, sellers or buyers for commercial use is strictly prohibited unless approved in writing by TRIANGLE APPRAISING SERVICES. However, images and documents may be given to the seller of the property for non-commercial, personal use. This license is not transferable. If further usage is desired for additional time frames and/or uses by the client and/or another person or entity, TRIANGLE APPRAISING SERVICES encourages contact for an estimate of the fee(s) which may be incurred and to obtain written permission to do so.