



House Measurements & Floor Plan

Property Address:
104 Fox Trail Ln, Morrisville, NC 27560

Prepared for:
Marzy Tritch
Fonville Morisey - Lochmere
April 9, 2018



Farshid Bondar
(919) 917-5490
TRIANGLE APPRAISING SERVICES

FLOOR PLAN & INTERIOR DIMENSIONS

FIRST FLOOR

Living Area: 621 sq ft

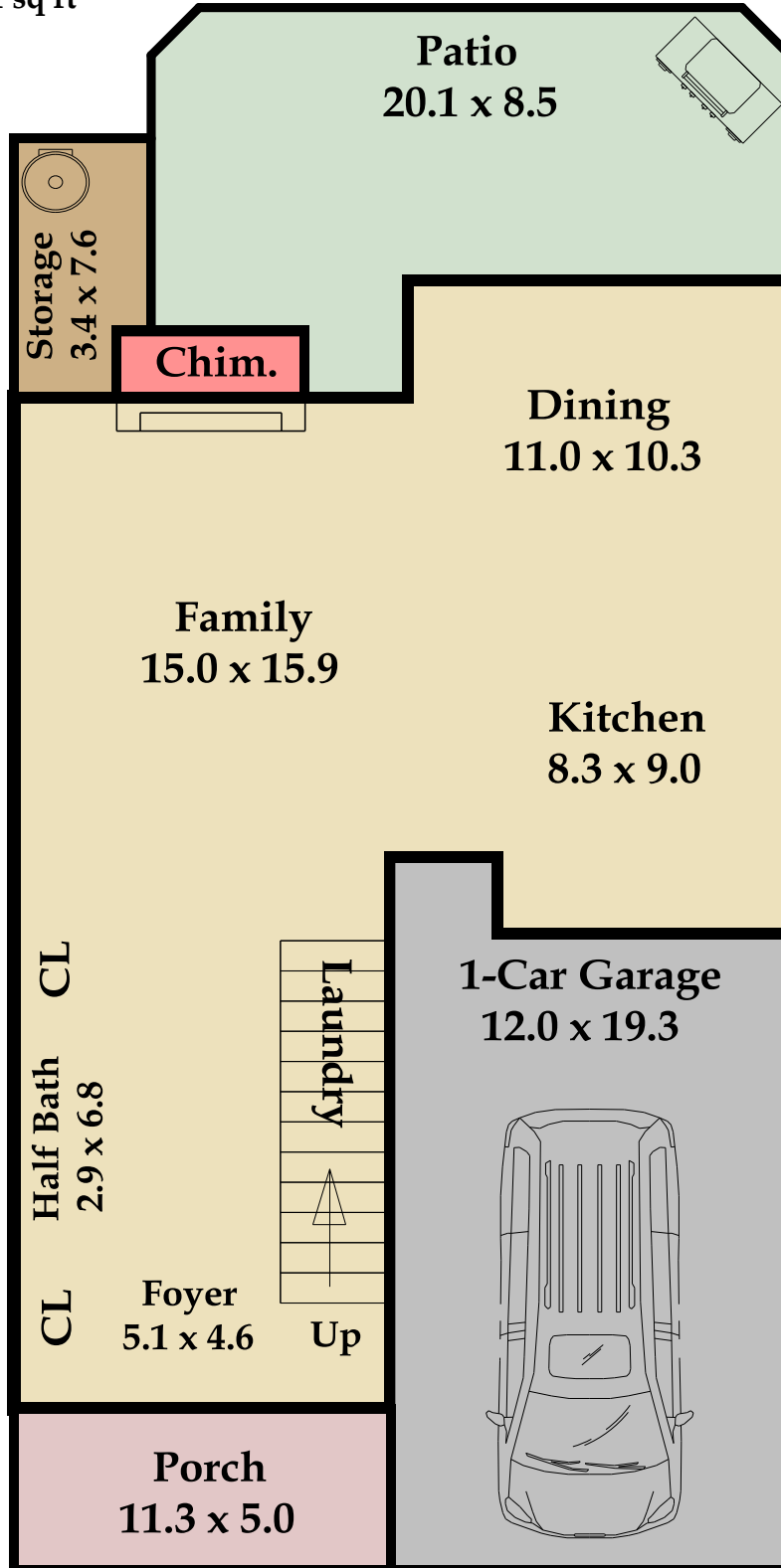

This floor plan is an approximation of existing structures and features and is provided for convenience only with the permission of the seller. All measurements are approximate and not guaranteed to be exact or to scale. Buyer should confirm measurements using their own sources. It is assumed that all workmanship in the existing property has been done according to local industry standards and permits duly obtained.

FLOOR PLAN & INTERIOR DIMENSIONS

SECOND FLOOR

Living Area: 880 sq ft

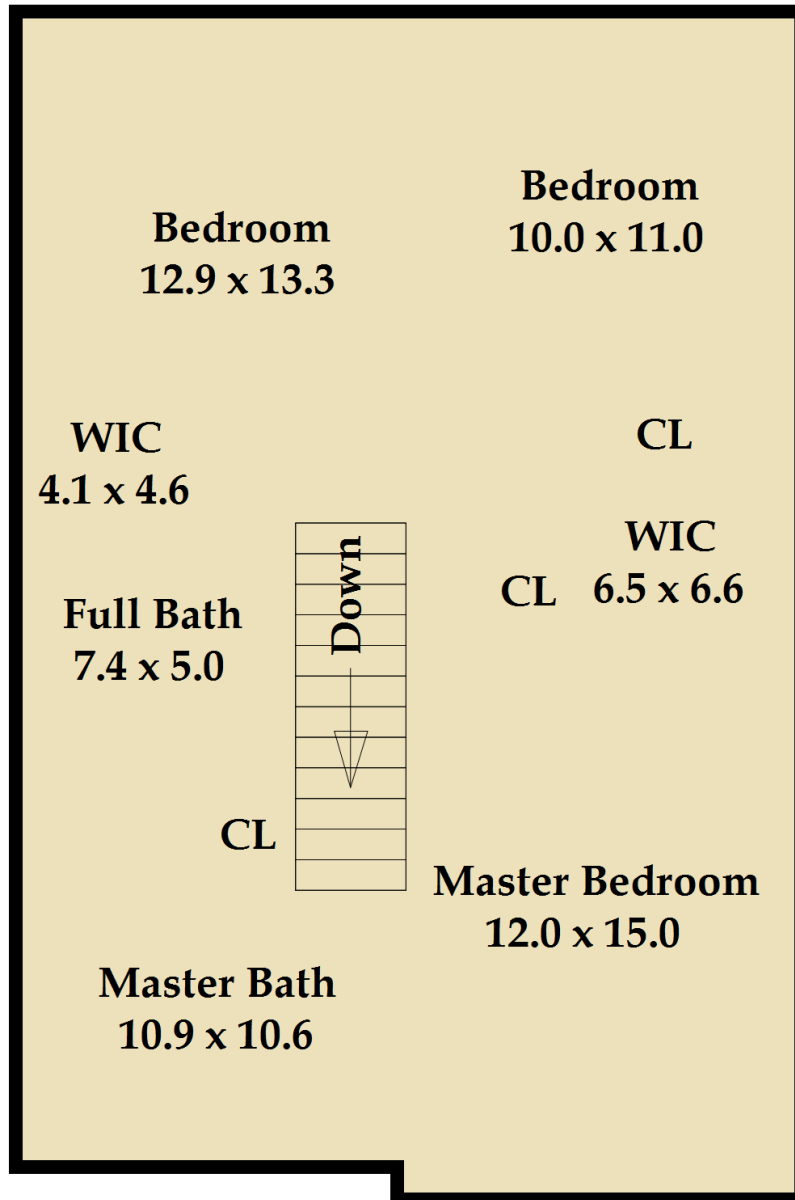

LIVING AREA CALCULATION DETAILS

TOTAL LIVING AREA:	1,501 sq ft
First Floor Living Area:	621 sq ft
Second Floor Living Area:	880 sq ft
Patio Area:	187 sq ft
Porch Area:	57 sq ft
Storage Area:	33 sq ft
1-Car Garage Area:	257 sq ft

Living Area	Calculation Details	
First Floor	621.16 Sq ft	$11.8 \times 17.25 = 203.55$ $14.45 \times 12.3 = 177.74$ $12 \times 18.15 = 217.8$ $2.4 \times 9.2 = 22.08$
Second Floor	880.01 Sq ft	$24.3 \times 35.7 = 867.51$ $1 \times 12.5 = 12.5$
Total Living Area (Rounded):	1501 Sq ft	

Usage License

Use of images and documents will be granted to the real estate agent client and their brokerage for the sole purpose of marketing the specific property, including distribution to the Triangle MLS, feeds, and syndication. This usage is limited to the duration of the listing as long as the real estate agent client is representing the sale of the property.

The real estate agent client may also use the documents listed above for an unlimited time period beyond the listing time frame in their local area for their self-promotion.

TRIANGLE APPRAISING SERVICES retains copyright of all images and documents.

Any usage of the images and documents by a third party, including but not limited to, a new listing agent, architects, builders, stagers, designers, sellers or buyers for commercial use is strictly prohibited unless approved in writing by TRIANGLE APPRAISING SERVICES. However, images and documents may be given to the seller of the property for non-commercial, personal use. This license is not transferable. If further usage is desired for additional time frames and/or uses by the client and/or another person or entity, TRIANGLE APPRAISING SERVICES encourages contact for an estimate of the fee(s) which may be incurred and to obtain written permission to do so.