



House Measurements & Floor Plan

Property Address:
2917 Meadowview Court, Apex, NC 27539

Prepared for:
Jenn Rowland
Fonville Morisey - Lochmere
July 3, 2019



Farshid Bondar
(919) 917-5490
www.TriangleAppraisingServices.com

FLOOR PLAN & INTERIOR DIMENSIONS

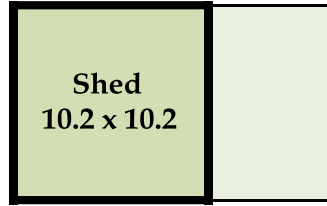

Treehouse

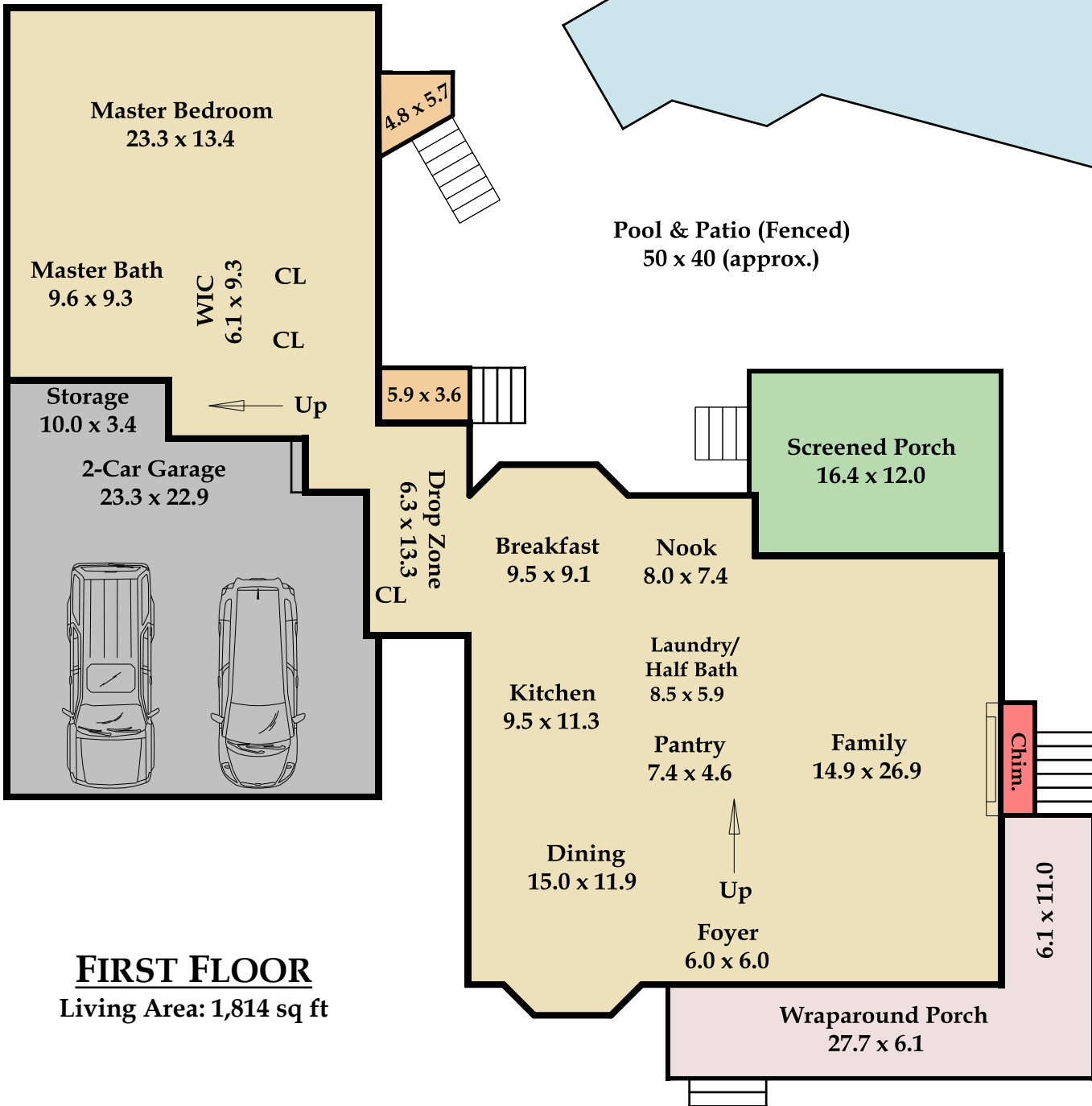
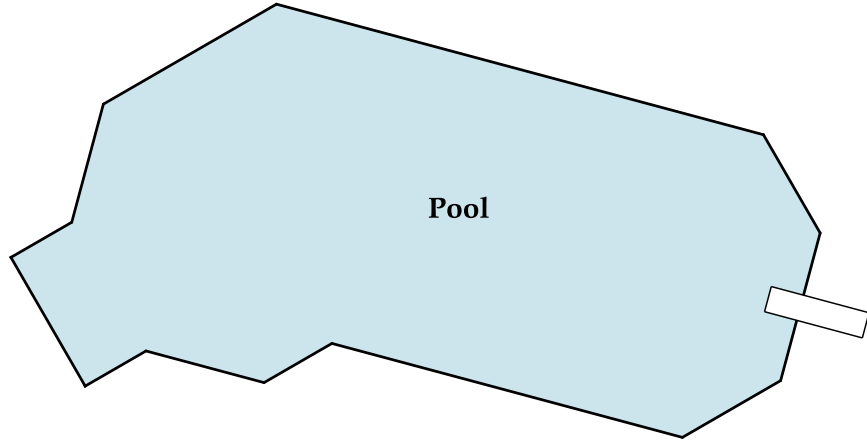

FIRST FLOOR

Living Area: 1,814 sq ft

FLOOR PLAN & INTERIOR DIMENSIONS

SECOND FLOOR

Living Area: 772 sq ft

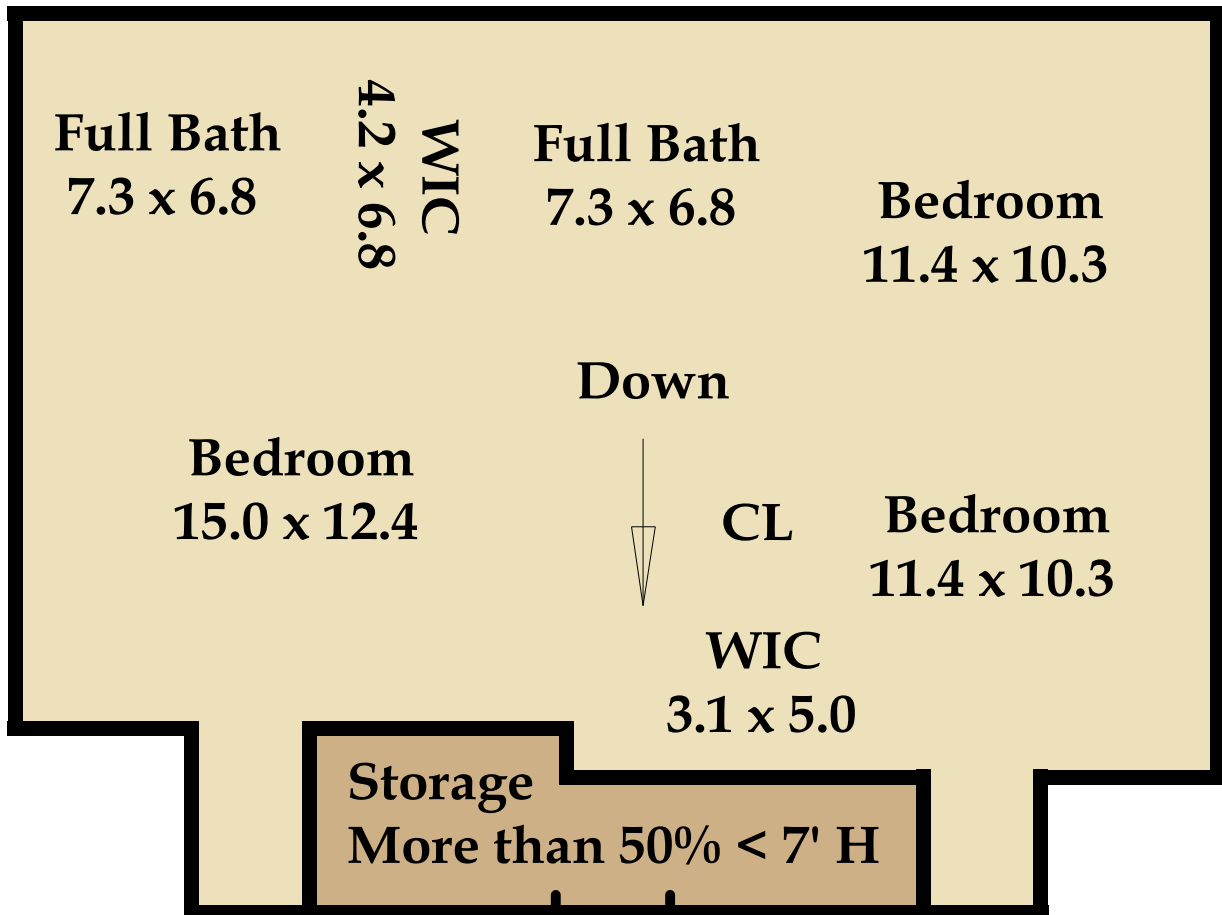

FLOOR PLAN & INTERIOR DIMENSIONS

SECOND FLOOR

Living Area: 750 sq ft

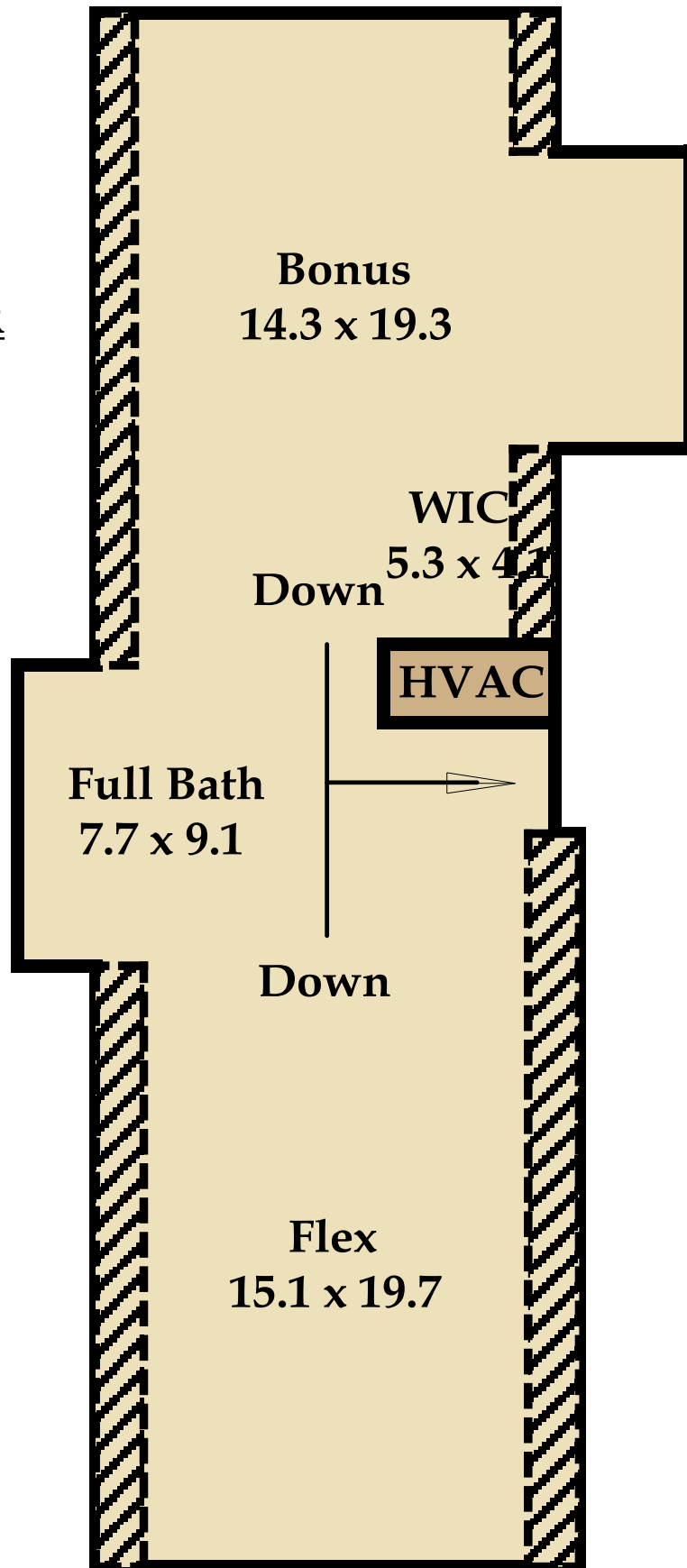

LIVING AREA CALCULATION DETAILS

Living Area		Calculation Details	
First Floor	1814.11 Sq ft	$0.5 \times 2 \times 2$	= 2
		$0.5 \times 2 \times 2$	= 2
		6.3×2	= 12.6
		$0.5 \times 2 \times 2$	= 2
		$0.5 \times 2 \times 2$	= 2
		5×2	= 10
		24.2×24.2	= 585.64
		34.7×22.7	= 787.69
		3.8×8.9	= 33.82
		4.8×2.8	= 13.44
		4.5×4	= 18
		6.7×4.7	= 31.49
		9.1×25.3	= 230.23
		16×5.2	= 83.2
Second Floor	772.42 Sq ft	3.4×5.3	= 18.02
		3.4×3.9	= 13.26
		22×18.8	= 413.6
		15.9×20.6	= 327.54
Second Floor	866.26 Sq ft	9.9×4.5	= 44.55
		10×2.6	= 26
		15.3×21	= 321.3
		16.1×24.4	= 392.84
		6.3×9.6	= 60.48
		3.7×5.7	= 21.09
Less than 5 ft Height	-41.48 Sq ft	24.4×1.7	= 41.48
Less than 5 ft Height	-32 Sq ft	1.6×20	= 32
Less than 5 ft Height	-28.21 Sq ft	1.3×21.7	= 28.21
Less than 5 ft Height	-6.44 Sq ft	1.4×4.6	= 6.44
Less than 5 ft Height	-9.1 Sq ft	6.5×1.4	= 9.1
Total Living Area (Rounded):		3336 Sq ft	

AREA SUMMARY

TOTAL LIVING AREA:	3,336 sq ft
First Floor Living Area:	1,814 sq ft
Second Floor Living Area:	1,522 sq ft
Screened Porch Area:	195 sq ft
Wraparound Porch Area:	235 sq ft
Deck Area:	41 sq ft
Storage Area:	79 sq ft
Pool & Patio Area (approx.):	2,000 sq ft
Shed Area:	104 sq ft
2-Car Garage Area:	580 sq ft

Usage License

Use of images and documents will be granted to the real estate agent client and their brokerage for the sole purpose of marketing the specific property, including distribution to the Triangle MLS, feeds, and syndication. This usage is limited to the duration of the listing as long as the real estate agent client is representing the sale of the property.

The real estate agent client may also use the documents listed above for an unlimited time period beyond the listing time frame in their local area for their self-promotion.

TRIANGLE APPRAISING SERVICES retains copyright of all images and documents.

Any usage of the images and documents by a third party, including but not limited to, a new listing agent, architects, builders, stagers, designers, sellers or buyers for commercial use is strictly prohibited unless approved in writing by TRIANGLE APPRAISING SERVICES. However, images and documents may be given to the seller of the property for non-commercial, personal use. This license is not transferable. If further usage is desired for additional time frames and/or uses by the client and/or another person or entity, TRIANGLE APPRAISING SERVICES encourages contact for an estimate of the fee(s) which may be incurred and to obtain written permission to do so.