



House Measurements & Floor Plan

Property Address:
109 Barcliff Terrace, Cary, NC 27518

Prepared for:
Larry & JoAnn McGhaw
Fonville Morisey - Lochmere
September 22, 2017



Farshid Bondar
(919) 917-5490
TRIANGLE APPRAISAL SERVICES

FLOOR PLAN & INTERIOR DIMENSIONS

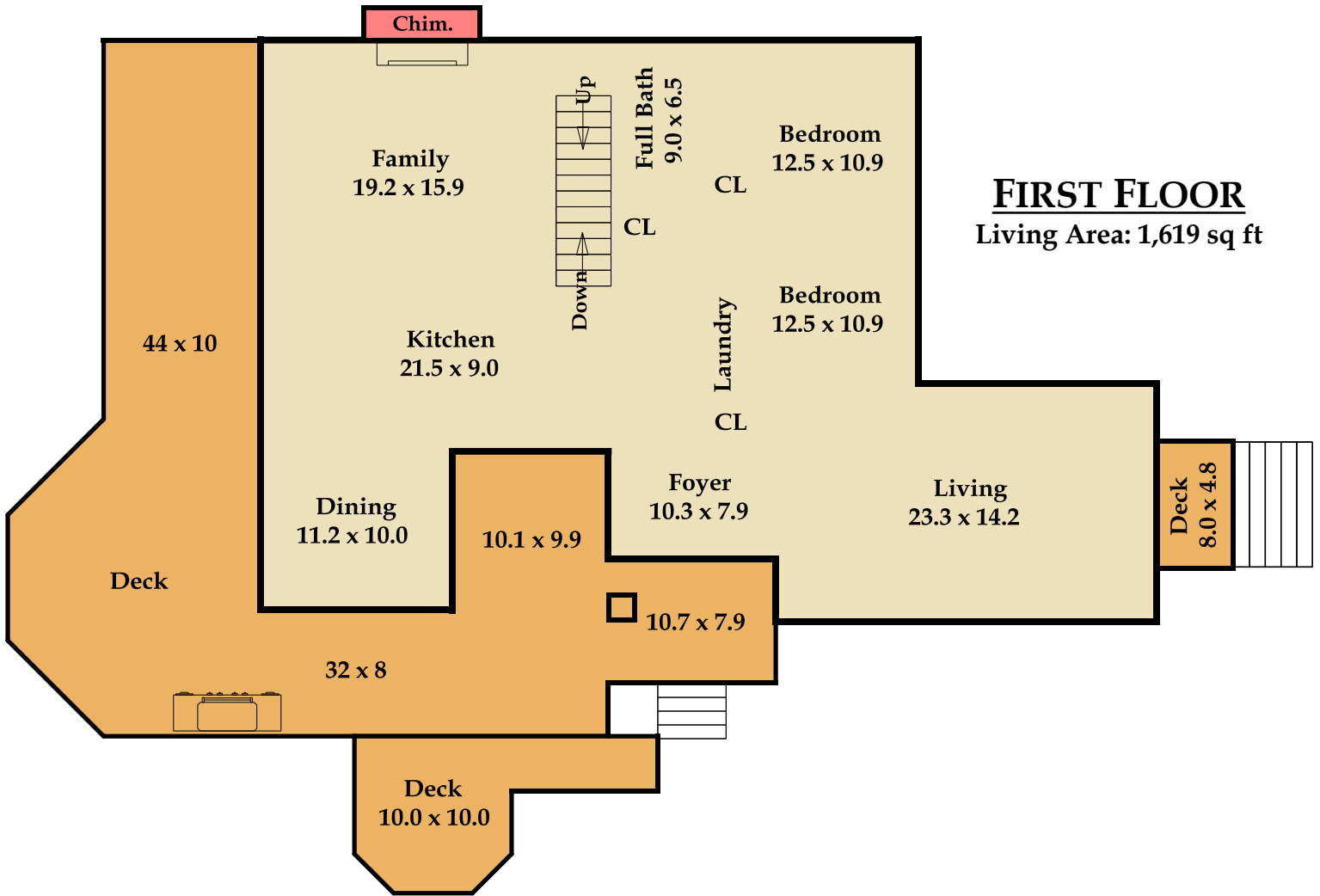

FIRST FLOOR
Living Area: 1,619 sq ft

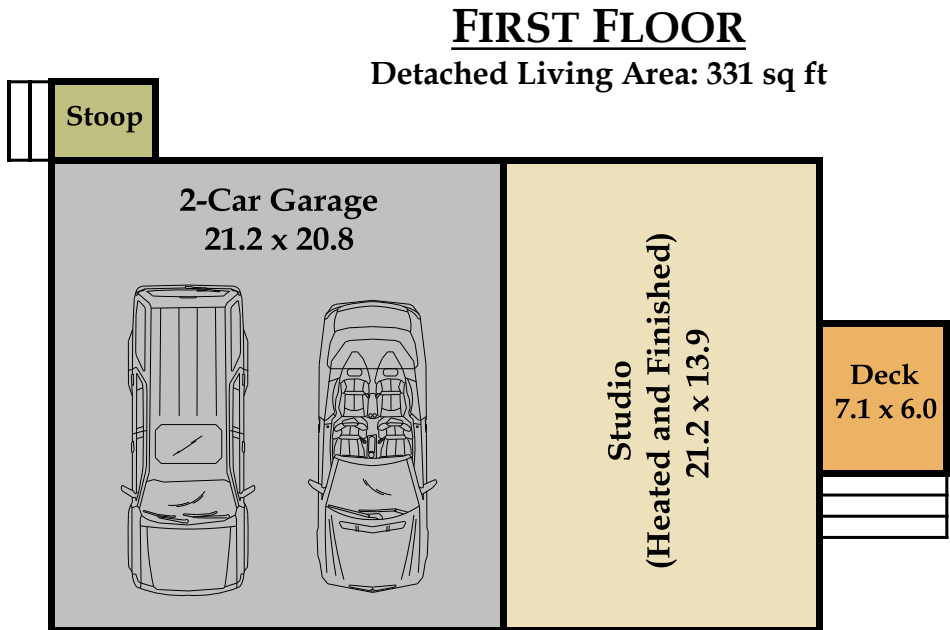

FIRST FLOOR
Detached Living Area: 331 sq ft

This floor plan is an approximation of existing structures and features and is provided for convenience only with the permission of the seller. All measurements are approximate and not guaranteed to be exact or to scale. Buyer should confirm measurements using their own sources. It is assumed that all workmanship in the existing property has been done according to local industry standards and permits duly obtained.

FLOOR PLAN & INTERIOR DIMENSIONS

SECOND FLOOR

Living Area: 361 sq ft

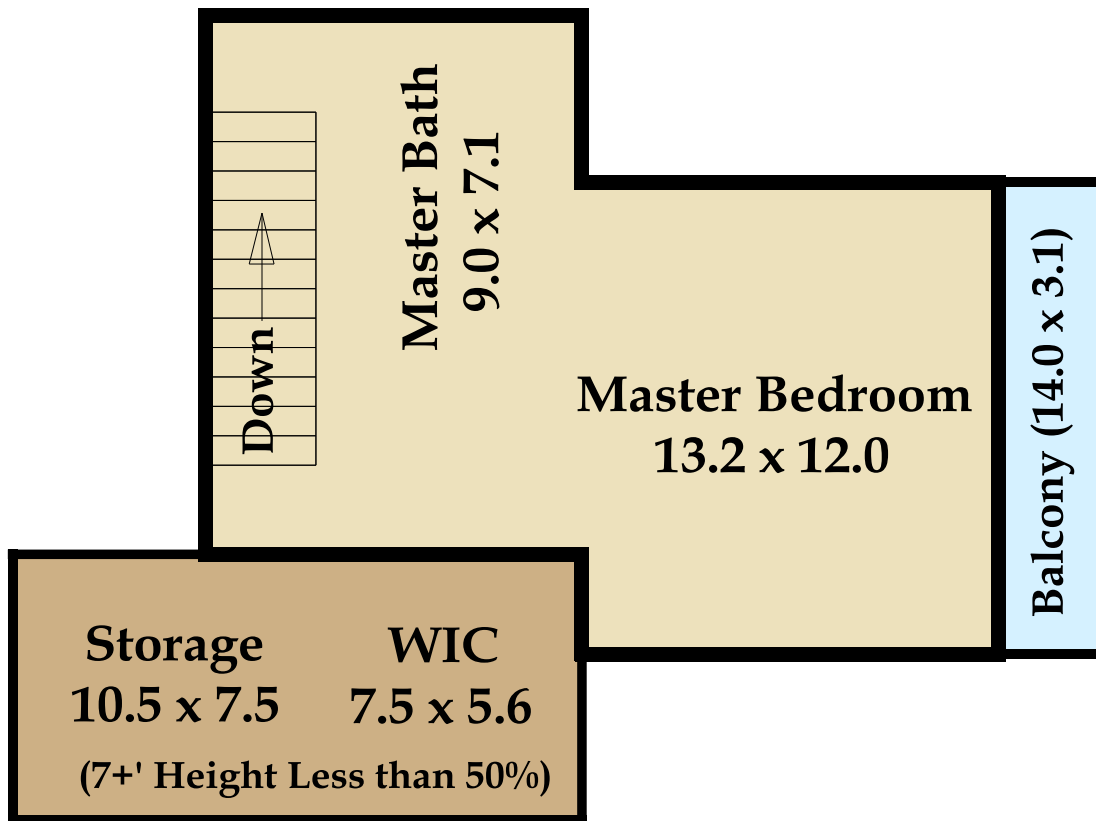

This floor plan is an approximation of existing structures and features and is provided for convenience only with the permission of the seller. All measurements are approximate and not guaranteed to be exact or to scale. Buyer should confirm measurements using their own sources. It is assumed that all workmanship in the existing property has been done according to local industry standards and permits duly obtained.

FLOOR PLAN & INTERIOR DIMENSIONS

BASEMENT

Living Area: 1,000 sq ft

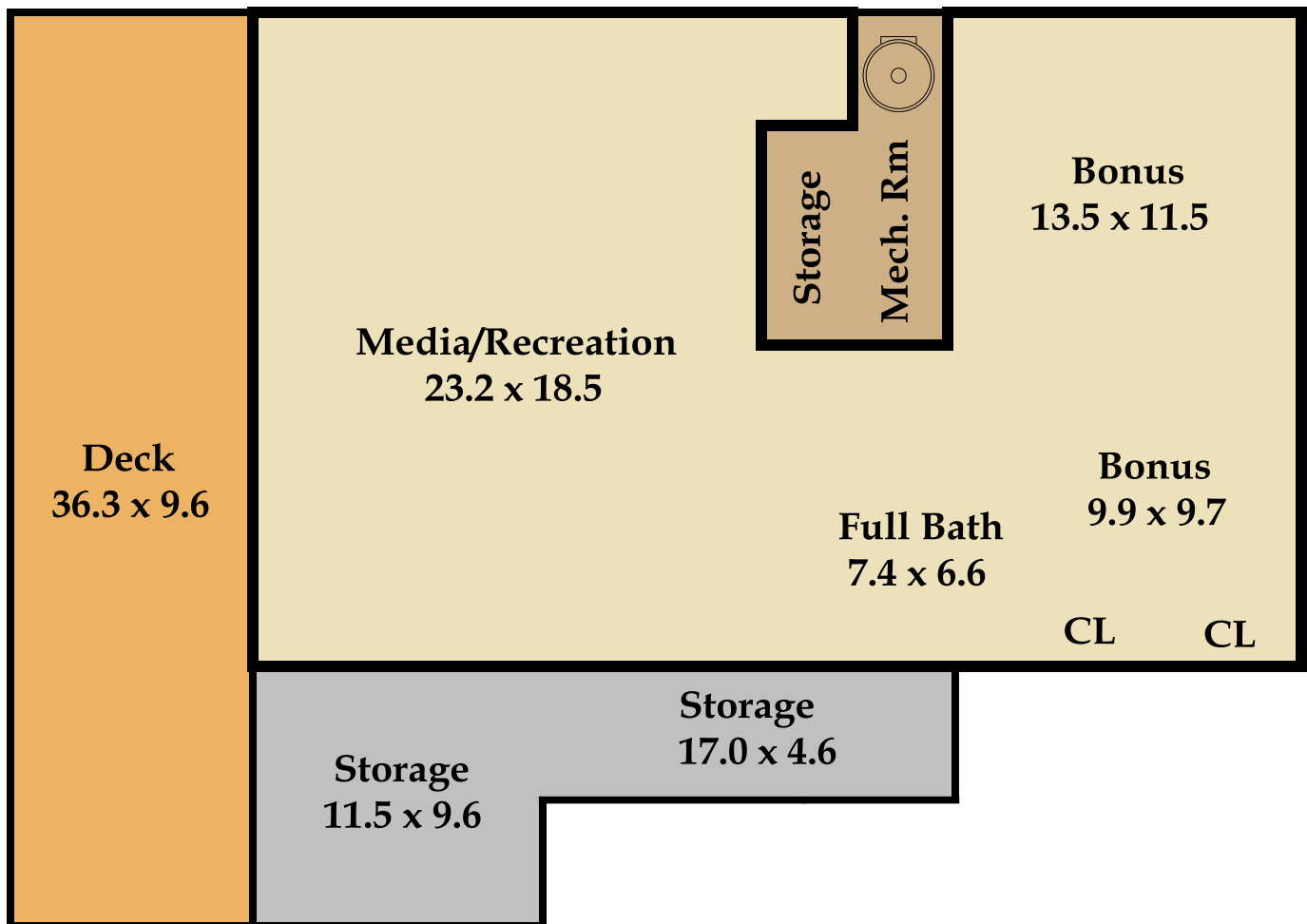

This floor plan is an approximation of existing structures and features and is provided for convenience only with the permission of the seller. All measurements are approximate and not guaranteed to be exact or to scale. Buyer should confirm measurements using their own sources. It is assumed that all workmanship in the existing property has been done according to local industry standards and permits duly obtained.

LIVING AREA CALCULATION DETAILS

TOTAL ATTACHED & DETACHED LIVING AREA:	3,311 sq ft
First Floor Living Area:	1,619 sq ft
First Floor Detached Living Area:	331 sq ft
Second Floor Living Area:	361 sq ft
Basement Living Area:	1,000 sq ft
Second Floor Closet/Storage Area:	149 sq ft

Living Area	Calculation Details	
First Floor	1619.05 Sq ft	$15.15 \times 15.15 = 229.52$ $41.8 \times 26.2 = 1095.16$ $10.85 \times 9.05 = 98.19$ $10.65 \times 6.85 = 72.95$ $10.1 \times 12.2 = 123.22$
Second Floor	360.56 Sq ft	$16.2 \times 11.3 = 183.06$ $12.5 \times 14.2 = 177.5$
Basement	1000.12 Sq ft	$41.6 \times 12.8 = 532.48$ $4.5 \times 3.6 = 16.2$ $20.2 \times 13.2 = 266.64$ $14 \times 13.2 = 184.8$
Total Living Area (Rounded):	2980 Sq ft	
Detached Living Area	330.78 Sq ft	$14.9 \times 22.2 = 330.78$

Usage License

Use of images and documents will be granted to the real estate agent client and their brokerage for the sole purpose of marketing the specific property, including distribution to the Triangle MLS, feeds, and syndication. This usage is limited to the duration of the listing as long as the real estate agent client is representing the sale of the property.

The real estate agent client may also use the documents listed above for an unlimited time period beyond the listing time frame in their local area for their self-promotion.

TRIANGLE APPRAISAL SERVICES retains copyright of all images and documents.

Any usage of the images and documents by a third party, including but not limited to, a new listing agent, architects, builders, stagers, designers, sellers or buyers for commercial use is strictly prohibited unless approved in writing by TRIANGLE APPRAISAL SERVICES. However, images and documents may be given to the seller of the property for non-commercial, personal use. This license is not transferable. If further usage is desired for additional time frames and/or uses by the client and/or another person or entity, TRIANGLE APPRAISAL SERVICES encourages contact for an estimate of the fee(s) which may be incurred and to obtain written permission to do so.