



House Measurements & Floor Plan

Property Address:
728 Lightfoot Dr., Clayton, NC 27520

Prepared for:
Suzan Smith
Fonville Morisey - Lochmere
April 12, 2018



Farshid Bondar
(919) 917-5490
TRIANGLE APPRAISING SERVICES

FLOOR PLAN & INTERIOR DIMENSIONS

Total Living Area: 2,156 sq ft



This floor plan is an approximation of existing structures and features and is provided for convenience only with the permission of the seller. All measurements are approximate and not guaranteed to be exact or to scale. Buyer should confirm measurements using their own sources. It is assumed that all workmanship in the existing property has been done according to local industry standards and permits duly obtained.

EXTERIOR FEATURES

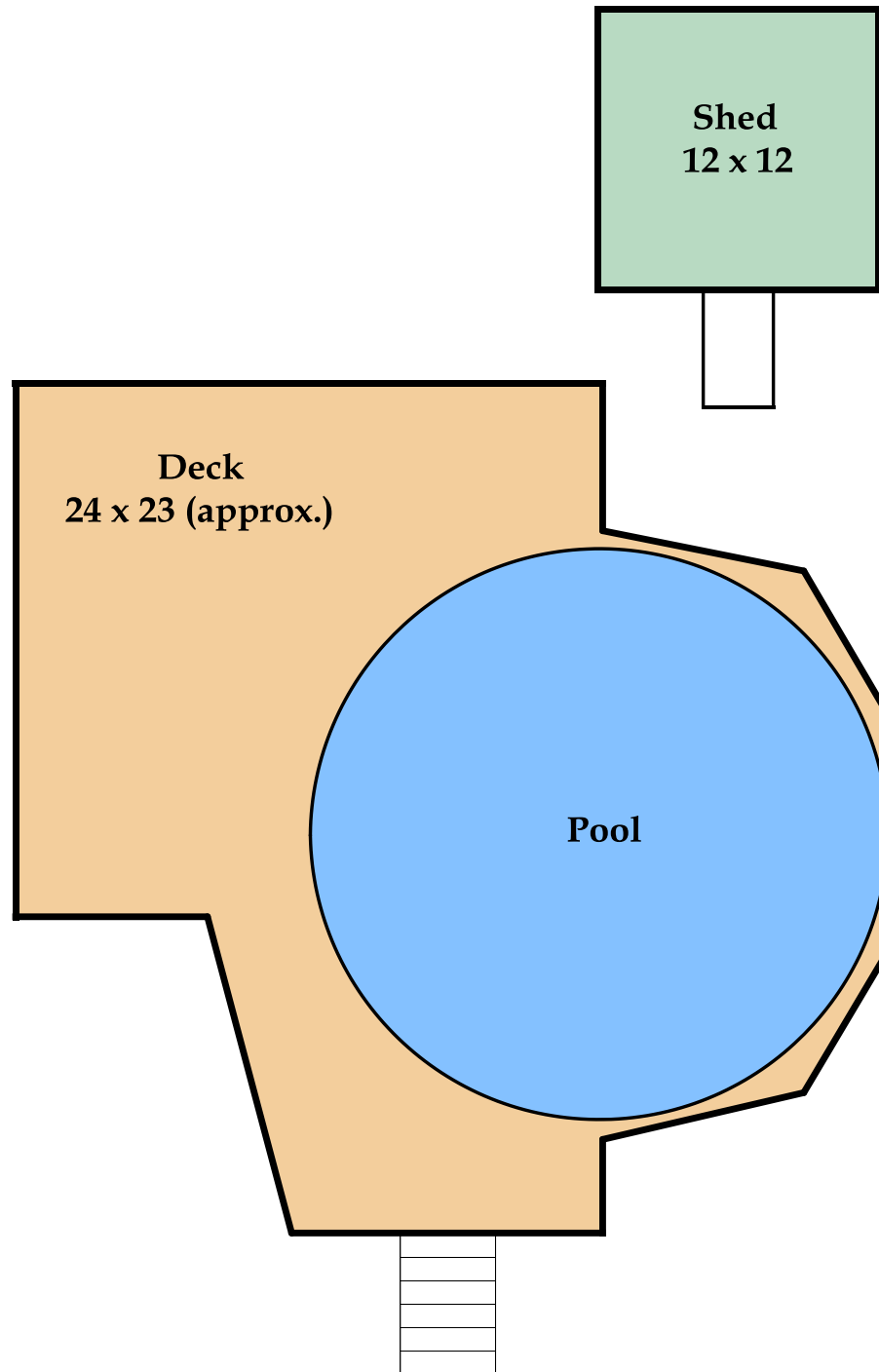

This floor plan is an approximation of existing structures and features and is provided for convenience only with the permission of the seller. All measurements are approximate and not guaranteed to be exact or to scale. Buyer should confirm measurements using their own sources. It is assumed that all workmanship in the existing property has been done according to local industry standards and permits duly obtained.

LIVING AREA CALCULATION DETAILS

TOTAL LIVING AREA:	2,156 sq ft
Deck Areas (approx.):	780 sq ft
Porch Area:	53 sq ft
Shed Area:	144 sq ft

Living Area	Calculation Details																																			
First Floor	<table style="width: 100%; border: none;"> <tr> <td style="text-align: right; width: 150px;">2155.58 Sq ft</td> <td style="width: 20px;"></td> <td style="padding: 2px 5px;">15.9×15</td> <td style="padding: 2px 5px;">=</td> <td style="padding: 2px 5px;">238.5</td> </tr> <tr> <td></td> <td></td> <td style="padding: 2px 5px;">$0.5 \times 2.05 \times 2.05$</td> <td style="padding: 2px 5px;">=</td> <td style="padding: 2px 5px;">2.1</td> </tr> <tr> <td></td> <td></td> <td style="padding: 2px 5px;">$0.5 \times 2.05 \times 2.05$</td> <td style="padding: 2px 5px;">=</td> <td style="padding: 2px 5px;">2.1</td> </tr> <tr> <td></td> <td></td> <td style="padding: 2px 5px;">6.15×2.05</td> <td style="padding: 2px 5px;">=</td> <td style="padding: 2px 5px;">12.61</td> </tr> <tr> <td></td> <td></td> <td style="padding: 2px 5px;">33.5×27</td> <td style="padding: 2px 5px;">=</td> <td style="padding: 2px 5px;">904.5</td> </tr> <tr> <td></td> <td></td> <td style="padding: 2px 5px;">31.45×23</td> <td style="padding: 2px 5px;">=</td> <td style="padding: 2px 5px;">723.35</td> </tr> <tr> <td></td> <td></td> <td style="padding: 2px 5px;">21.2×12.85</td> <td style="padding: 2px 5px;">=</td> <td style="padding: 2px 5px;">272.42</td> </tr> </table>	2155.58 Sq ft		15.9×15	=	238.5			$0.5 \times 2.05 \times 2.05$	=	2.1			$0.5 \times 2.05 \times 2.05$	=	2.1			6.15×2.05	=	12.61			33.5×27	=	904.5			31.45×23	=	723.35			21.2×12.85	=	272.42
2155.58 Sq ft		15.9×15	=	238.5																																
		$0.5 \times 2.05 \times 2.05$	=	2.1																																
		$0.5 \times 2.05 \times 2.05$	=	2.1																																
		6.15×2.05	=	12.61																																
		33.5×27	=	904.5																																
		31.45×23	=	723.35																																
		21.2×12.85	=	272.42																																
Total Living Area (Rounded):	2156 Sq ft																																			

Usage License
 Use of images and documents will be granted to the real estate agent client and their brokerage for the sole purpose of marketing the specific property, including distribution to the Triangle MLS, feeds, and syndication. This usage is limited to the duration of the listing as long as the real estate agent client is representing the sale of the property.
 The real estate agent client may also use the documents listed above for an unlimited time period beyond the listing time frame in their local area for their self-promotion.
 TRIANGLE APPRAISING SERVICES retains copyright of all images and documents.
 Any usage of the images and documents by a third party, including but not limited to, a new listing agent, architects, builders, stagers, designers, sellers or buyers for commercial use is strictly prohibited unless approved in writing by TRIANGLE APPRAISING SERVICES. However, images and documents may be given to the seller of the property for non-commercial, personal use. This license is not transferable. If further usage is desired for additional time frames and/or uses by the client and/or another person or entity, TRIANGLE APPRAISING SERVICES encourages contact for an estimate of the fee(s) which may be incurred and to obtain written permission to do so.