



## House Measurements & Floor Plan

Property Address:  
**108 Bending Oak Way, Morrisville, NC 27560**

Prepared for:  
**Linda Britt**  
**Fonville Morisey - Preston**  
**October 20, 2017**



**Farshid Bondar**  
**(919) 917-5490**  
**TRIANGLE APPRAISAL SERVICES**

# FLOOR PLAN & INTERIOR DIMENSIONS

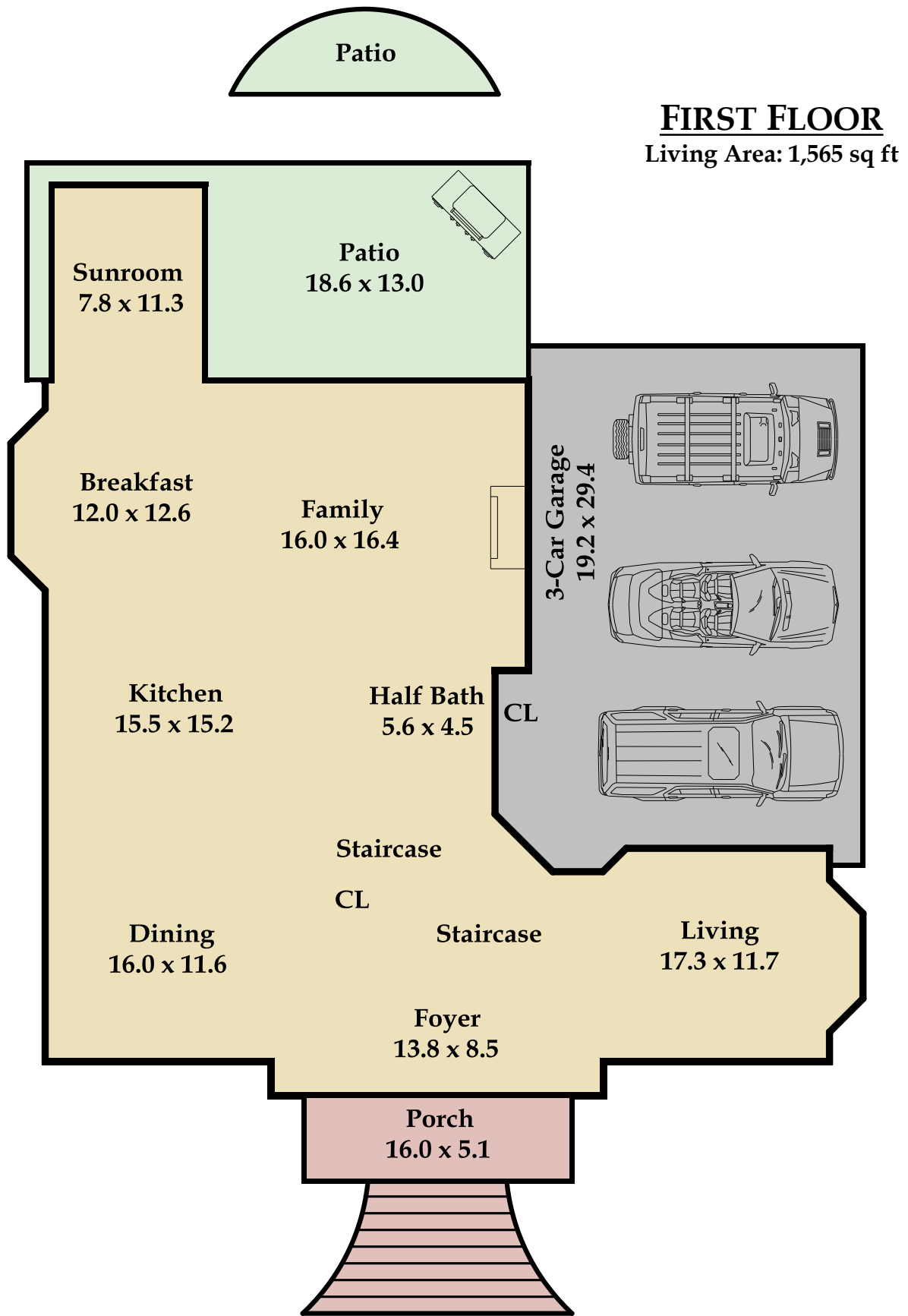

This floor plan is an approximation of existing structures and features and is provided for convenience only with the permission of the seller. All measurements are approximate and not guaranteed to be exact or to scale. Buyer should confirm measurements using their own sources. It is assumed that all workmanship in the existing property has been done according to local industry standards and permits duly obtained.

# FLOOR PLAN & INTERIOR DIMENSIONS

## SECOND FLOOR

Living Area: 1,653 sq ft

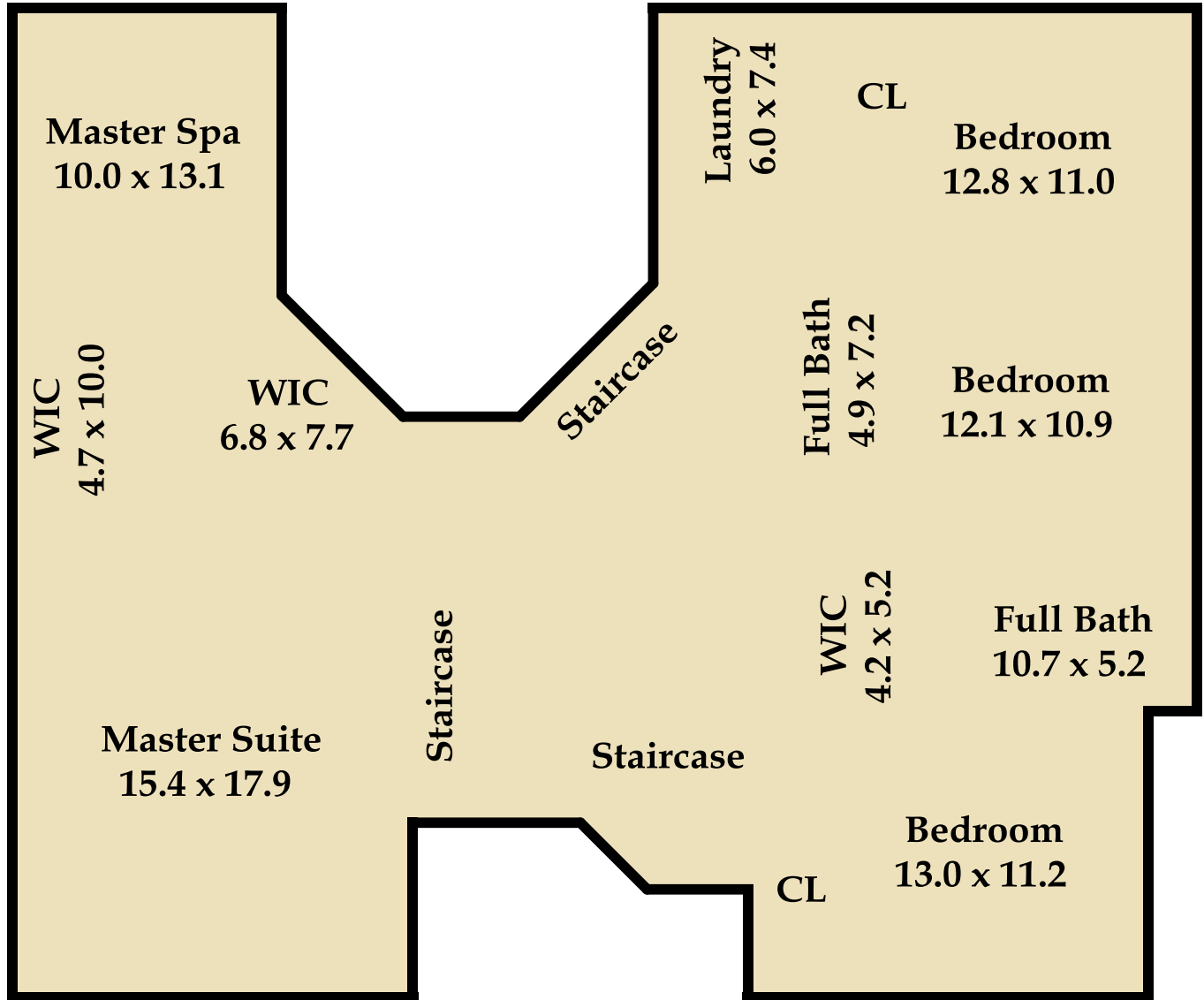

This floor plan is an approximation of existing structures and features and is provided for convenience only with the permission of the seller. All measurements are approximate and not guaranteed to be exact or to scale. Buyer should confirm measurements using their own sources. It is assumed that all workmanship in the existing property has been done according to local industry standards and permits duly obtained.

# FLOOR PLAN & INTERIOR DIMENSIONS

## THIRD FLOOR

Living Area: 712 sq ft

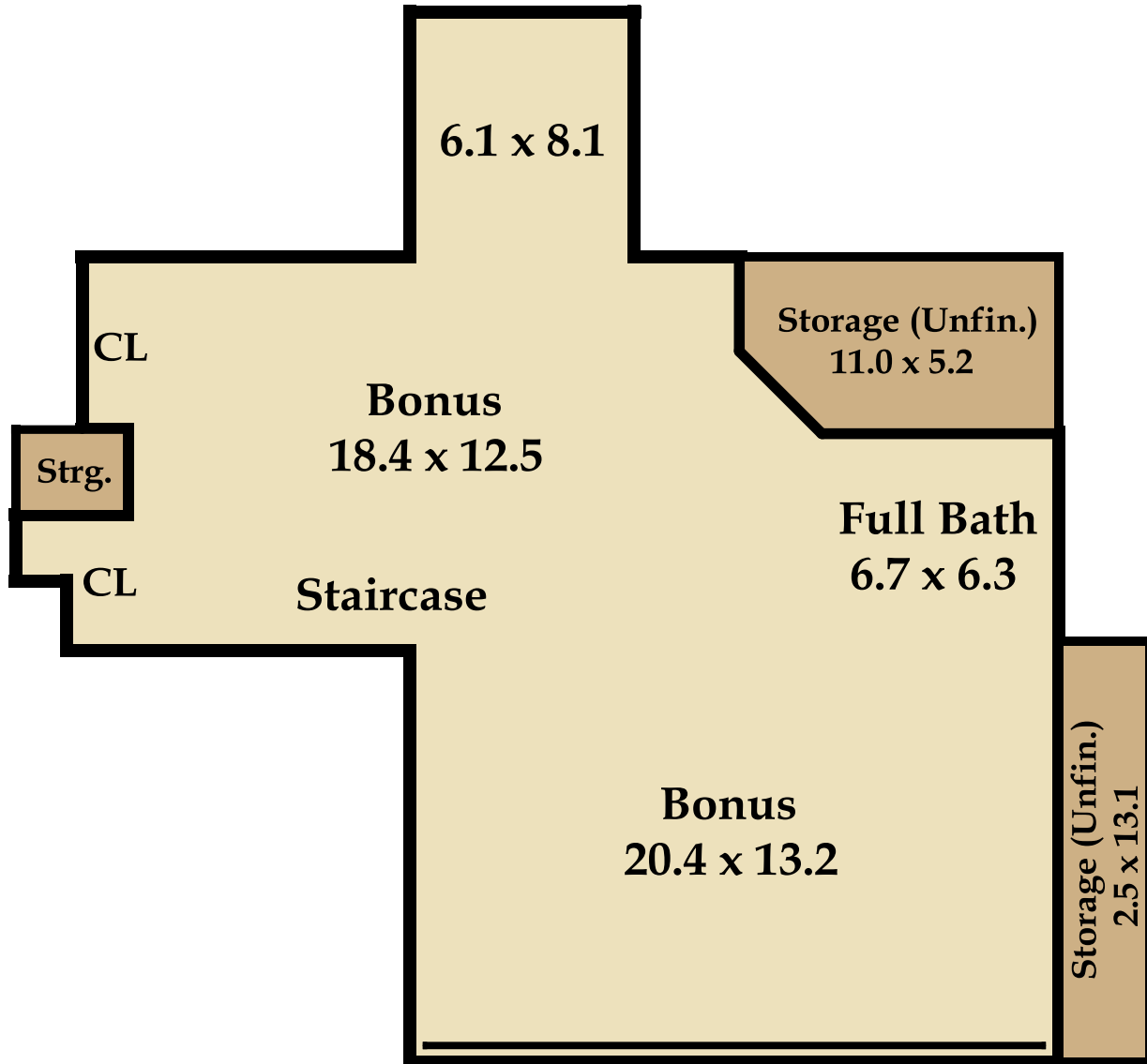

## LIVING AREA CALCULATION DETAILS

|                                  |                    |
|----------------------------------|--------------------|
| <b>TOTAL LIVING AREA:</b>        | <b>3,930 sq ft</b> |
| <b>First Floor Living Area:</b>  | <b>1,565 sq ft</b> |
| <b>Second Floor Living Area:</b> | <b>1,653 sq ft</b> |
| <b>Third Floor Living Area:</b>  | <b>712 sq ft</b>   |

| Living Area                         |                   | Calculation Details  |
|-------------------------------------|-------------------|--|
| First Floor                         | 1564.52 Sq ft     | $0.5 \times 2 \times 2 = 2$<br>$0.5 \times 2 \times 2 = 2$<br>$5.1 \times 2 = 10.2$<br>$19.9 \times 2.05 = 40.8$<br>$0.5 \times 2.05 \times 2.05 = 2.1$<br>$0.5 \times 2.05 \times 2.05 = 2.1$<br>$6.75 \times 2.05 = 13.84$<br>$9.25 \times 11.7 = 108.22$<br>$12.75 \times 12.15 = 154.91$<br>$40.8 \times 26.9 = 1097.52$<br>$7.85 \times 11.35 = 89.1$<br>$0.5 \times 1.4 \times 1.4 = 0.98$<br>$0.5 \times 3.45 \times 3.45 = 5.95$<br>$2 \times 17.4 = 34.8$ |
| Second Floor                        | 1653.09 Sq ft     | $16.5 \times 7.2 = 118.8$<br>$16.5 \times 4.45 = 73.42$<br>$0.5 \times 2.75 \times 2.75 = 3.78$<br>$20.65 \times 2.75 = 56.79$<br>$46.8 \times 4.6 = 215.28$<br>$48.8 \times 12.15 = 592.92$<br>$0.5 \times 5 \times 5 = 12.5$<br>$11.1 \times 5 = 55.5$<br>$11.1 \times 11.85 = 131.54$<br>$0.5 \times 5.5 \times 5.5 = 15.12$<br>$22.4 \times 5.5 = 123.2$<br>$22.4 \times 11.35 = 254.24$   |
| Third Floor                         | 714.12 Sq ft      | $7.4 \times 8.1 = 59.94$<br>$2.2 \times 1.7 = 3.74$<br>$21.4 \times 13.6 = 291.04$<br>$7.2 \times 7.8 = 56.16$<br>$4.5 \times 2 = 9$<br>$22.9 \times 7.2 = 164.88$<br>$5.7 \times 1.5 = 8.55$<br>$5.8 \times 20.2 = 117.16$<br>$0.5 \times 2.7 \times 2.7 = 3.64$  |
| Less than 5 ft Height               | -2.04 Sq ft       | $20.4 \times 0.1 = 2.04$   |
| <b>Total Living Area (Rounded):</b> | <b>3930 Sq ft</b> |  |

### Usage License

Use of images and documents will be granted to the real estate agent client and their brokerage for the sole purpose of marketing the specific property, including distribution to the Triangle MLS, feeds, and syndication. This usage is limited to the duration of the listing as long as the real estate agent client is representing the sale of the property.

The real estate agent client may also use the documents listed above for an unlimited time period beyond the listing time frame in their local area for their self-promotion.

TRIANGLE APPRAISAL SERVICES retains copyright of all images and documents.

Any usage of the images and documents by a third party, including but not limited to, a new listing agent, architects, builders, stagers, designers, sellers or buyers for commercial use is strictly prohibited unless approved in writing by TRIANGLE APPRAISAL SERVICES. However, images and documents may be given to the seller of the property for non-commercial, personal use. This license is not transferable. If further usage is desired for additional time frames and/or uses by the client and/or another person or entity, TRIANGLE APPRAISAL SERVICES encourages contact for an estimate of the fee(s) which may be incurred and to obtain written permission to do so.